

CCH ACCESSIBLE BEDS/BATHS PLAN 2-12-2013

Scale: 1/4" = 1'-0"

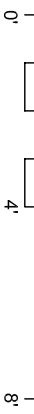

Clear Creek House at  
ILLINOIS YEARLY MEETING  
Quaker Lane

McNabb, IL 61335

Grade Elev. -1'-2"

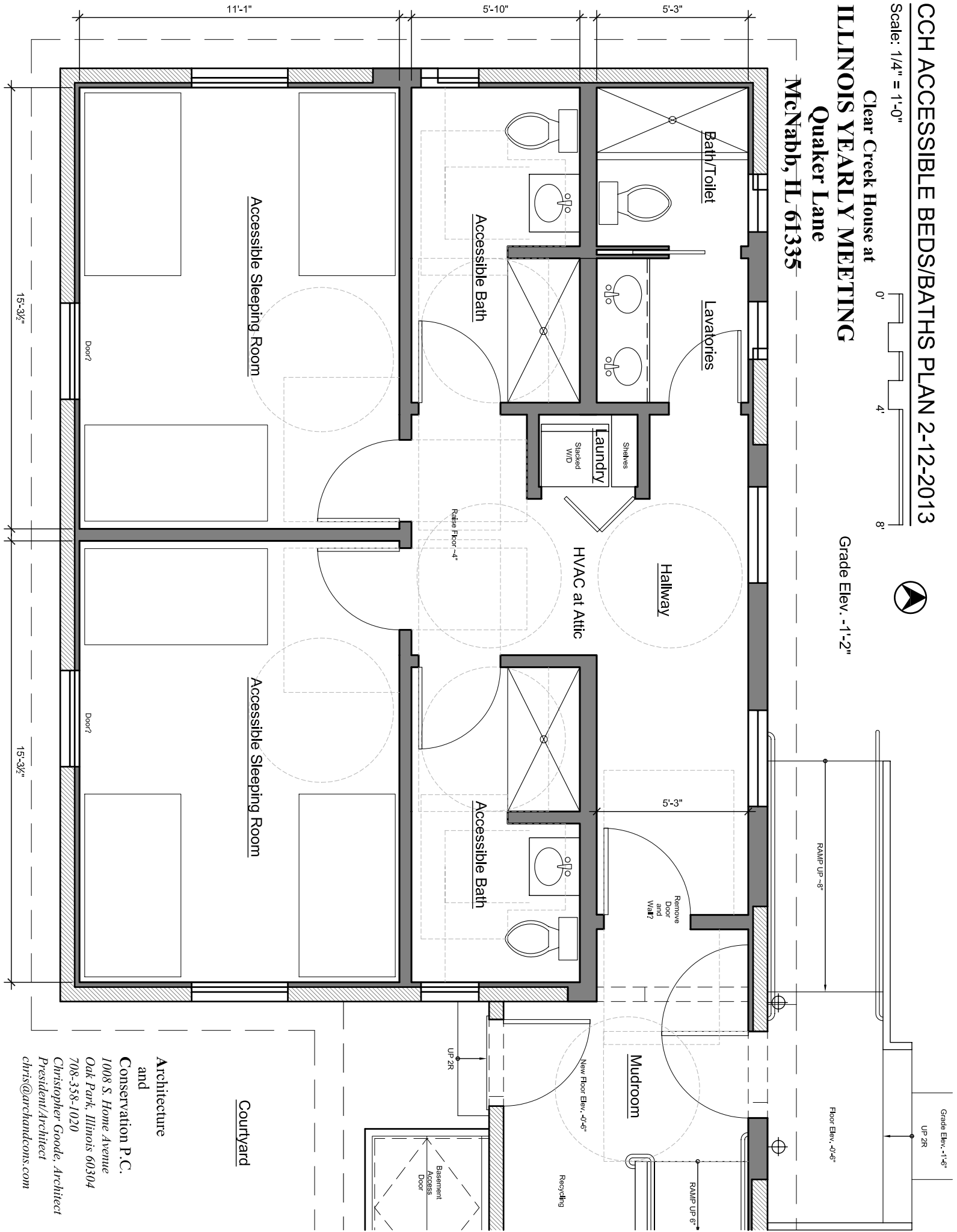

Architecture  
and  
Conservation P. C.  
1008 S. Home Avenue  
Oak Park, Illinois 60304  
708-358-1020  
Christopher Gooke, Architect  
President/Architect  
chris@archandcons.com